

# NIAGARA STRAIGHT SIDE PRESSES

FORM A-13-F

'C' TYPE CUSHION

**WARNING**  
NEVER APPLY MORE THAN 5 PSI ON  
CUSHION WITH BOLSTER OFF PRESS  
OR WITH CUSHION OUT OF PRESS.

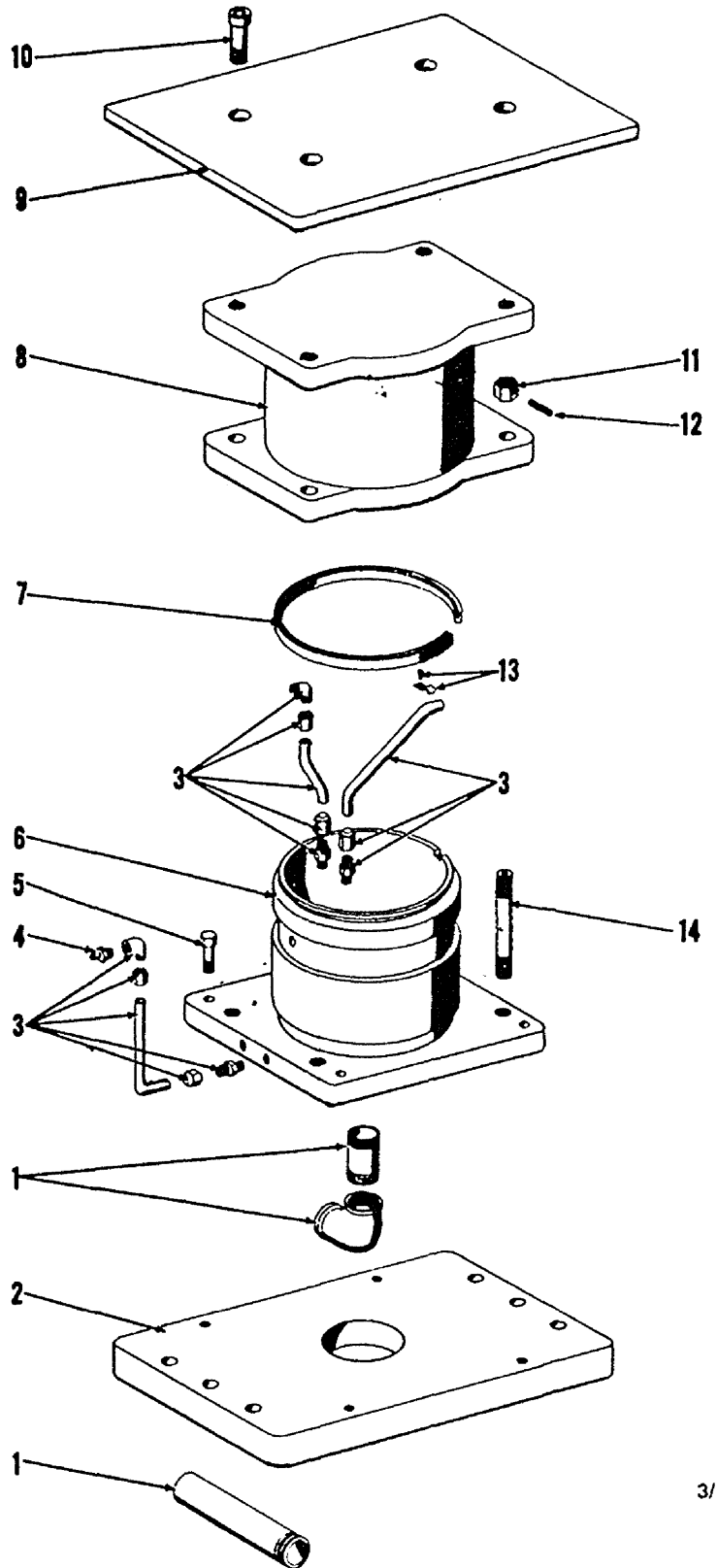

1. Air Piping (Furnished by Customer)
2. Mounting Plate
3. Lubrication Piping
4. Oil Fitting
5. Cylinder Mounting Screw
6. Cylinder
7. "U" Packing (Split for illustration purposes only)
8. Piston
9. Pressure Plate
10. Pressure Plate Mounting Screw
11. Stop Nut
12. Roll Pin
13. Lubrication Pipe Clip and Screw
14. Positive Stop Stud