

PARTS LIST

When ordering parts always give the catalog and serial number of the shear. The serial number is stamped at or near the front left corner of the bed and also on the metal lubrication plate. Be sure to use complete names of parts listed for positive identification.

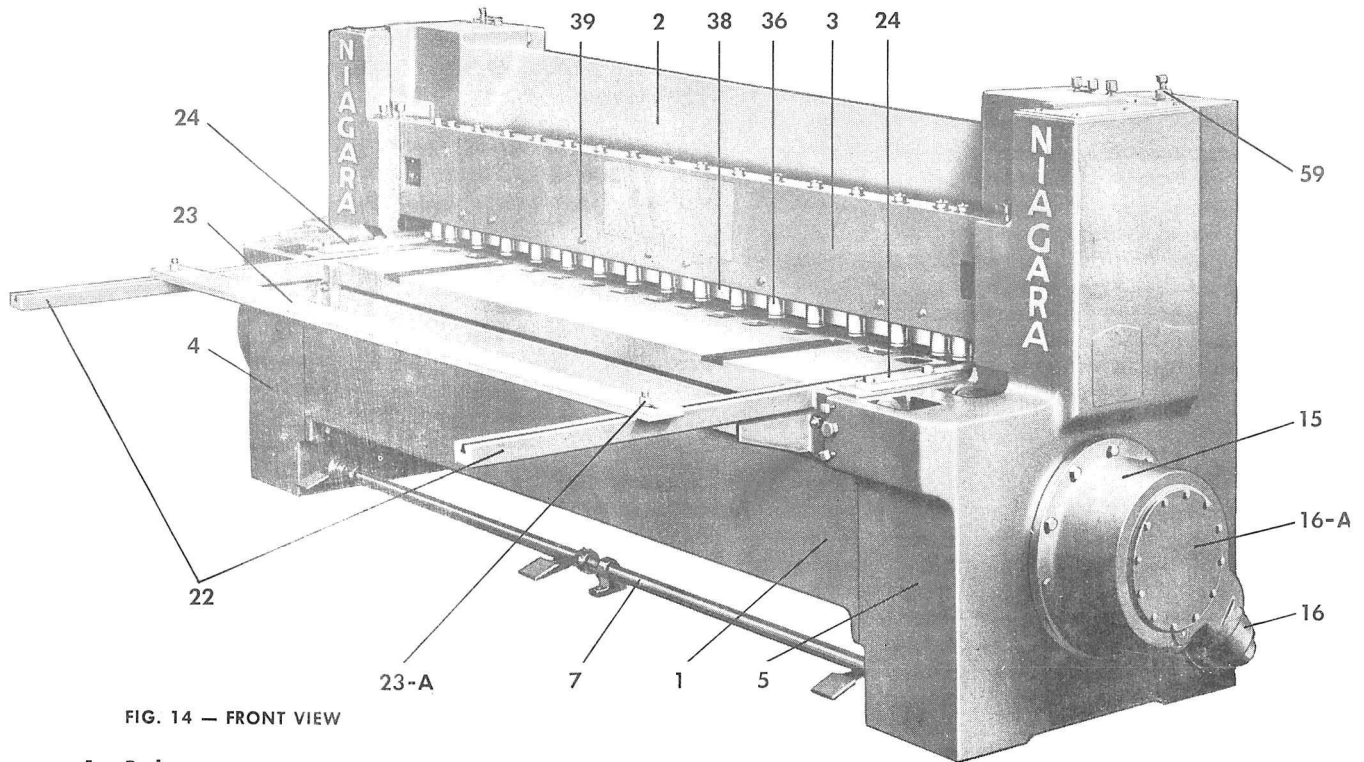

FIG. 14 — FRONT VIEW

- | | | |
|-----------------------|----------------------------|-------------------------------|
| 1. Bed | 15. Detent Cam Box | 24. Side Gage |
| 2. Cross Head | 16. Detent Spring Pot | 36. Holddown Foot |
| 3. Holddown | 16-A. Detent Cam Box Cover | 38. Knife Guard |
| 4. Left Hand Housing | 22. Front Brackets | 39. Knife Guard Bolt |
| 5. Right Hand Housing | 23. Front Gage | 59. Counterbalance Spring Rod |
| 7. Treadle Shaft | 23-A. Front Gage Bolts | |

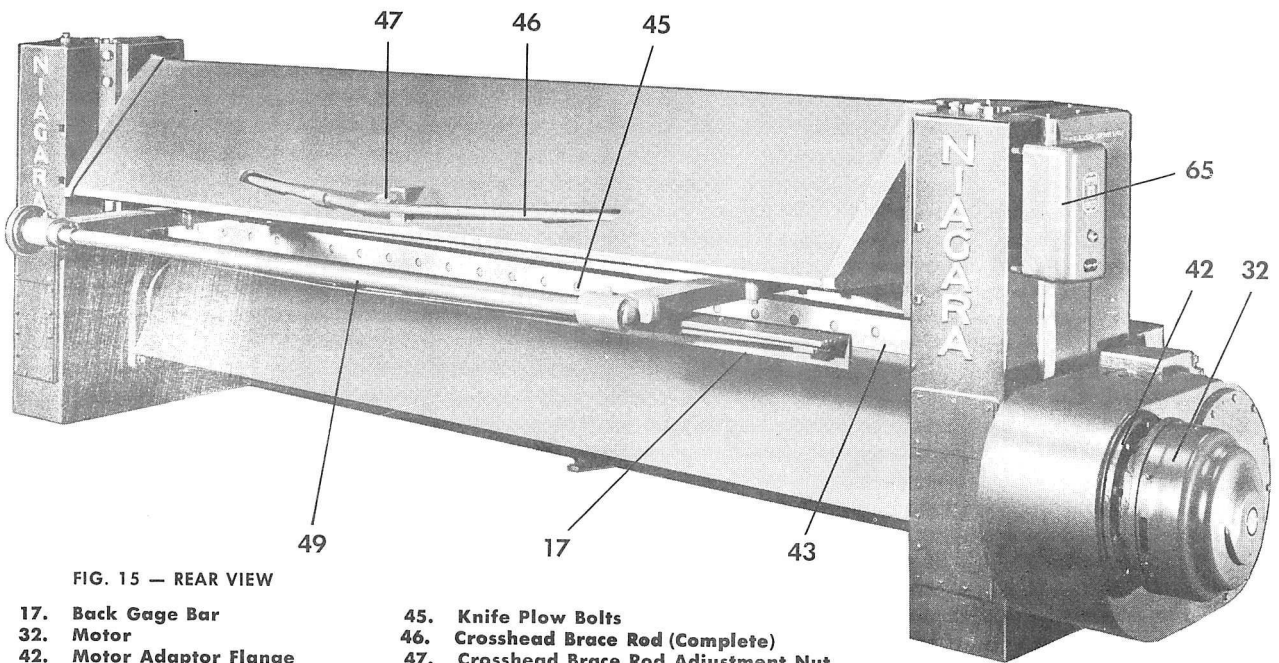
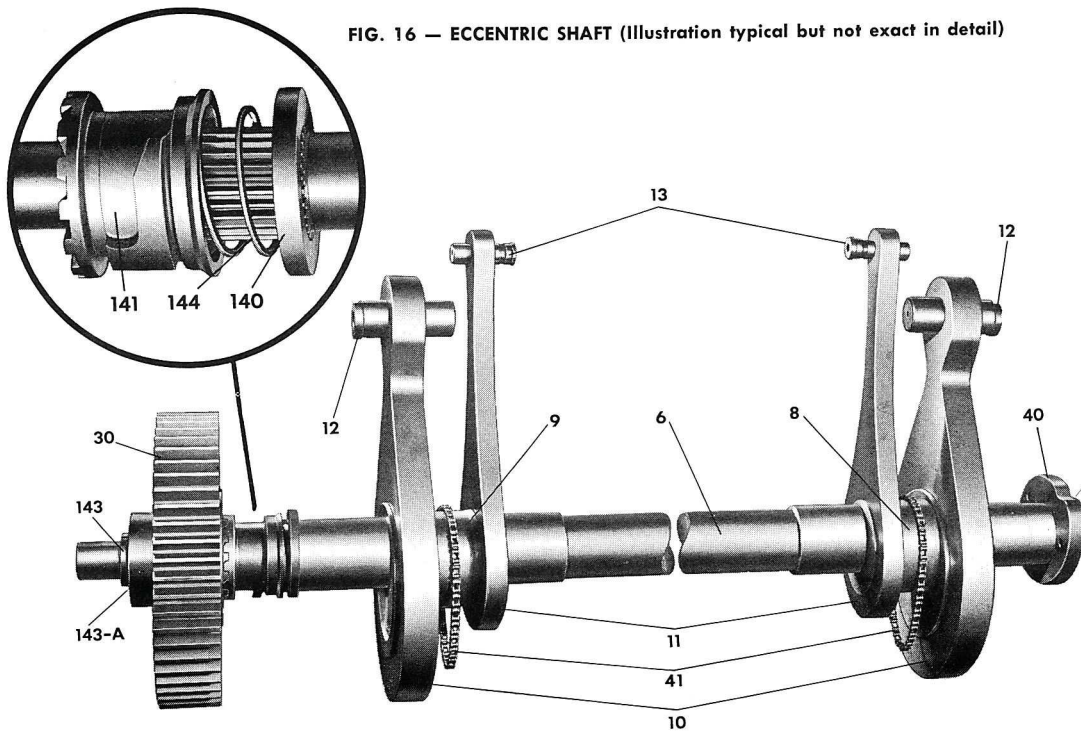

FIG. 15 — REAR VIEW

- | | |
|--------------------------|--|
| 17. Back Gage Bar | 45. Knife Plow Bolts |
| 32. Motor | 46. Crosshead Brace Rod (Complete) |
| 42. Motor Adaptor Flange | 47. Crosshead Brace Rod Adjustment Nut |
| 43. Lower Knife | 49. Back Gage Squaring Shaft |
| *44. Upper Knife | 65. Motor Starter |

* Not Illustrated

FIG. 16 — ECCENTRIC SHAFT (Illustration typical but not exact in detail)



- | | | |
|--------------------------------|---------------------------|---------------------------|
| 6. Eccentric Shaft | 12. Crosshead Wrist Pins | 140. Single Stroke Cam |
| 8. R.H. Eccentric | 13. Holddown Wrist Pins | 141. Clutch Sleeve |
| 9. L.H. Eccentric | 30. Clutch Gear | 143. Locknut |
| 10. Crosshead Eccentric Straps | 40. Detent Cam | * 143-A Lockwasher |
| 11. Holddown Eccentric Straps | 41. Eccentric Oiler Chain | 144. Clutch Sleeve Spring |

* Not Illustrated

FIG. 17 — DETENT BRAKE

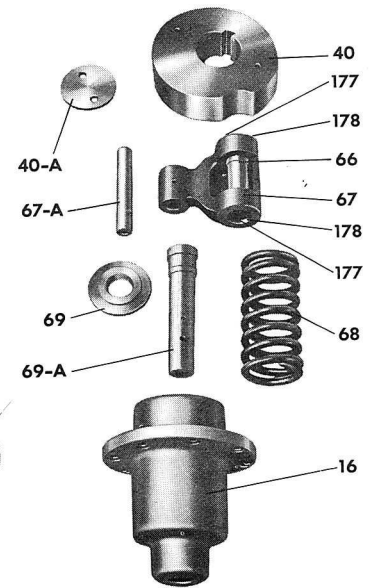

- | |
|-----------------------------------|
| 16. Detent Spring Pot |
| 40. Detent Cam |
| 40-A Detent Cam Housing Washer |
| 66. Detent Cam Roller |
| 67. Detent Cam Lever |
| 67-A Detent Lever Pin |
| 68. Detent Spring |
| 69. Detent Spring Plunger |
| 69-A Detent Plunger Stem |
| 177. Detent Cam Roller Bearings |
| 178. Detent Cam Roller Snap Rings |

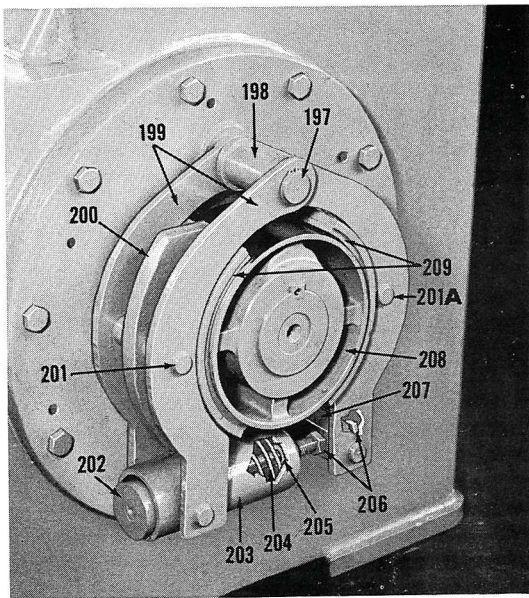
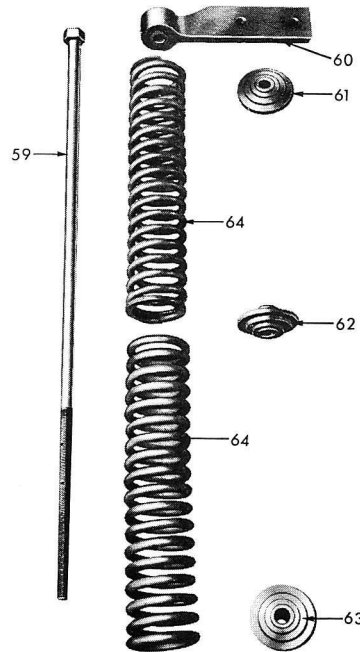

FIG. 17-A — FRICTION BRAKE

- | |
|-----------------------|
| 197. Brake Pivot Pin |
| 198. Pivot Spacer |
| 199. Brake Lever Arm |
| 200. Brake Shoe |
| 201. Brake Shoe Pin |
| 201-A. Brake Shoe Pin |
| 202. Spring Rod |
| 203. Spring Rod |
| 204. Spring |
| 205. Formica Bushing |
| 206. Nut |
| 207. Trunnion |
| 208. Brake Collar |
| 209. Brake Lining |

FIG. 18 — COUNTERBALANCE



- | |
|---|
| 59. Counterbalance Spring Rod |
| 60. Crosshead Spring Bracket |
| 61. Upper Counterbalance Spring Washer |
| 62. Center Counterbalance Spring Washer |
| 63. Lower Counterbalance Spring Washer |
| 64. Counterbalance Springs |

FIG. 19 — HOLDDOWN ASSEMBLY AND KNIFE GUARD MOUNTING SCREW

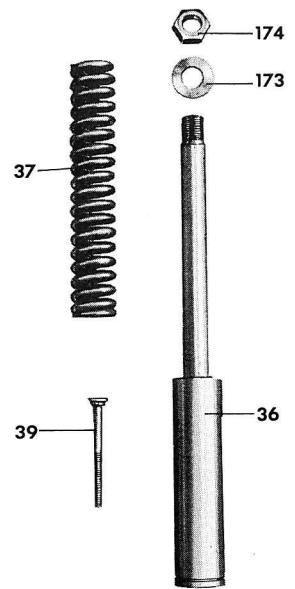

- | |
|---------------------|
| 36. Holddown Foot |
| 37. Holddown Spring |
| 39. Knifeguard Bolt |
| 173. Washer |
| 174. Nut |

FIG. 20 — SERIES 12 GEAR BOX

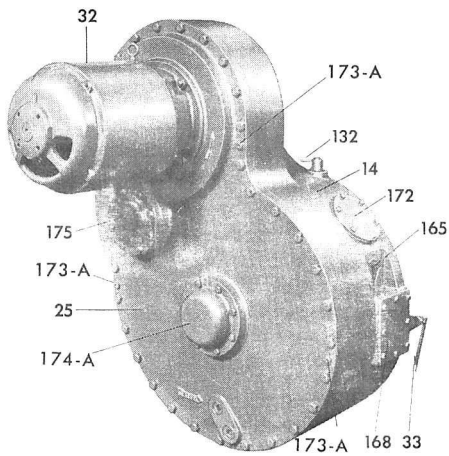

- 14. Gear Box
- 25. Gear Box Cover
- 32. Motor
- 33. Treadle Connection
- 132. Locking Bar Handle
- 165. Single Stroke Cam Cover
- 168. Inspection Cover
- 172. Oil Fill Cover
- 173-A. Dowel Pins; Total of Four
- 174-A. Eccentric Shaft Cover
- 175. Intermediate Pinion Shaft Cover

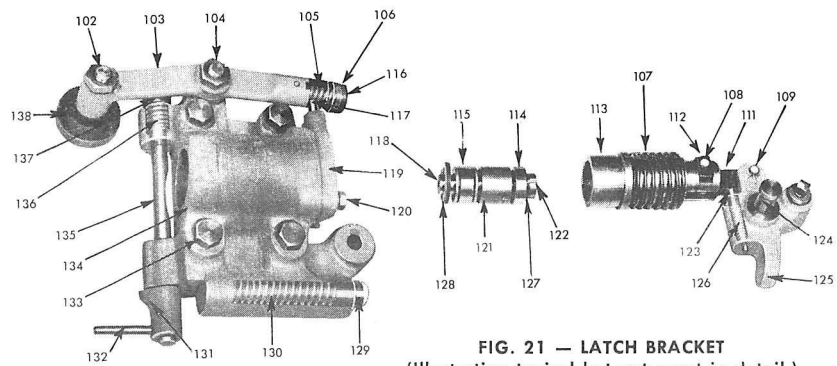

FIG. 21 — LATCH BRACKET
(Illustration typical but not exact in detail.)

- 102. Cam Roller Shaft
- 103. Cam Lever
- 104. Cam Lever Pin
- 105. Selector Knob Spring
- 106. Single Stroke Selector Knob
- 107. Throwout Spring
- 108. Throwout Pin
- 109. Latch Hinge Pin
- 111. Latch
- 112. Throwout Key
- 113. Throwout
- 114. Throwout Bearing Ball
- 115. Throwout Bearing Needle
- 116. Selector Knob Pin
- 117. Sliding Pin
- 118. Throwout Shaft
- 119. Throwout Housing End Cover
- 120. End Cover Cap Screw
- 121. Spacing Collar
- 122. Throwout Shaft Lock Nut
- 123. Latch Spring Pin
- 124. Bell Crank Pin
- 125. Bell Crank
- 126. Latch Spring
- 127. Lock Washer
- 128. Throwout Shaft Collar Nuts
- 129. Treadle Spring Plunger
- 130. Treadle Spring
- 131. Locking Bar Indicator
- 132. Locking Bar Handle
- 133. Throwout Housing Cap Screw
- 134. Throwout Housing
- 135. Locking Bar
- 136. Locking Bar Spring
- 137. Locking Bar End Collar
- 138. Cam Roller

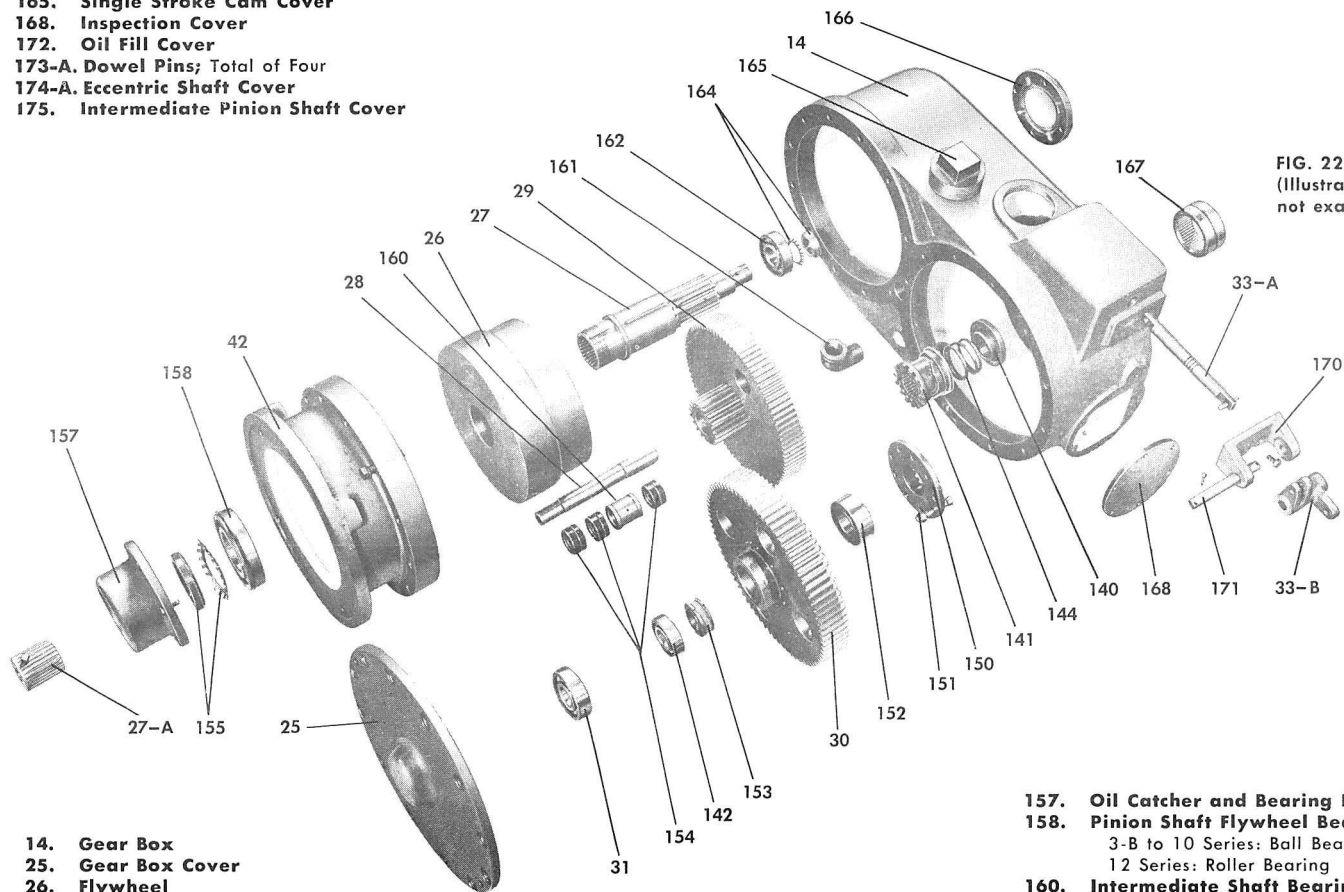

FIG. 22 — GEAR BOX
(Illustration typical but not exact in detail.)

- 14. Gear Box
- 25. Gear Box Cover
- 26. Flywheel
- 27. Drive Shaft
- 27-A Splined Motor Coupling
- 28. Intermediate Shaft
(Does not apply to 10 and 12 Series)
- 29. Intermediate Gear and Pinion Cluster
- 30. Clutch Gear
- 31. Cover Bearing
(Does not apply to 8 and 9 Series)
- 33-A Treadle Connecting Link
- 33-B Upper Treadle Lever
- 42. Motor Adapter Flange
- 140. Single Stroke Cam
- 141. Clutch Sleeve
- 142. Outer Clutch Gear Bearings
3-B to 9 Series: Single Row Ball Bearing;
10 and 12 Series: Timken Tapered Bearing.

- 144. Clutch Sleeve Spring
- 150. Clutch Wheel Face
- 151. Clutch Face Bolt and Nut
- 152. Inner Clutch Gear Bearing
3-B to 9 Series: Double Row Ball Bearing;
10 and 12 Series: Timken Tapered Bearing.
- 153. Clutch Gear Bearing Spacer
- 154. Intermediate Shaft Bearings
3B to 5B Series: 3 Needle Bearings
6 and 7B Series: 4 Needle Bearings
8 and 9 Series: 2 Bronze Bushings
10 and 12 Series: Needle Bearing Each End of Shaft
- 155. Locknut and Washer

- 157. Oil Catcher and Bearing Retainer
- 158. Pinion Shaft Flywheel Bearing
3-B to 10 Series: Ball Bearing
12 Series: Roller Bearing
- 160. Intermediate Shaft Bearing Spacer
Does not apply to 10 and 12 Series
- 161. Oil Level Elbow
- 162. Pinion Shaft Bearing
3-B to 5-B and 12 Series: Ball Bearing
6 and 7-B Series: Roller Bearings
8 to 10 Series: Double Row Ball Bearings
- 164. Locknut and Washer
- 165. Single Stroke Cam Cover
- 166. Eccentric Shaft Bearing Cover
- 167. Eccentric Shaft Bearing
3-B to 5-B Series: Needle Bearing
6 and 7-B Series: 2 Needle Bearings
8 to 12 Series: Floating Bronze Bushings
- 168. Inspection Cover
- 170. Treadle Lever Bracket
- 171. Treadle Lever Pin

LUBRICATION CHART

Mobil Oil Company Engineers cooperating with our own staff recommended the following or equivalent lubricants.

Thoroughly oil bearings after each shutdown *before* starting shear and frequently thereafter. Keep bearings and oil clean and free from dirt or grit. The plain bearings of this shear are not designed to accommodate any type

of grease. The oil recommended has a special compounding for the purpose and its use is highly advocated. **ORDINARY AUTOMOTIVE AND MACHINE OILS ARE NOT CONSIDERED SATISFACTORY.**

POINTS OF LUBRICATION	PARTS	LUBRICANT	METHOD OF APPLYING	REMARKS
A	Gear Box	Mobil Compound Oil BB	Fill through plug or cover, top of gear box	Drain and refill after first three months; thereafter, change oil every six months. Maintain oil level.
B	Leg Housings	Mobil Vactra Oil Extra Heavy	Fill through cover on rear of leg	Drain and clean wells once each year. Maintain oil level.
C	Gibs Holddowns and Counterbalance	Mobil Vactra Oil Extra Heavy	Oil cups	Fill oil cups until full before starting shear. After each shutdown, refill cups several times during each shift. Put a few drops of oil on top of each holddown foot.
D	Wrist Pins	Mobil Grease Sovarex L-1	3-B to 8 Series grease gun	Fill until grease shows on both sides of connection. <i>Keep well lubricated.</i>
		Mobil Compound Oil BB	9-10-12 Series oil cups	Fill oil cups until full before starting and after each shutdown. <i>Keep well lubricated.</i>
E	Backgage Gearbox	Mobil Grease Sovarex L-1	Fill through plug by spooning	Check every six months.
F	Backgage Screws & Slide	Mobil Grease Sovarex L-1	Spread liberally on screws and slideways	Check every three months.
G	Motor	Follow motor manufacturer's recommendations		

	SERIES SHEAR	3-B	4-B	5-B	6	7-B	8	9	10	12
Gear Box Oil Capacities Given for Each Series Shear	Capacity in Gallons	1½	2	2½	3	3	4	5	6	8
Leg Housing Oil Capacities. Figure Given Is Total of Both Housings	Capacity in Gallons	5	8	11	14	14	22	29	31	33

POINTS OF LUBRICATION

(SEE CHART ON PAGE 18)

