

NIAGARA

STRAIGHT SIDE PRESSES

FORM A-13-M-1

SINGLE GEARED TWIN END DRIVE

NOTE: Machines with clutch on driveshaft, Serial No. 47200 and above - Once each year remove cover on clutch and lubricate flywheel bearings through fitting on the end of the driveshaft. Use Chevron SR-1 No. 2 grease.

12. Clutch Hub
13. Retainer Ring
14. Brake Hub
15. Ring Gasket
16. Flywheel
17. Inboard Flywheel Bearing
18. Spacer
19. Outboard Flywheel Bearing
21. Clutch (See Separate Parts List)
22. L. H. Bearing Housing
23. Retainer Ring
24. Locating Bearing
25. Retainer Ring
26. L. H. Intermediate Shaft
27. Retainer Ring
28. Roller Bearing
29. Retainer Ring
30. L. H. Bearing Cartridge
31. L. H. Coupling (Consists of Two Pieces)
32. Middle Intermediate Shaft
33. R. H. Coupling (Consists of Two Pieces)
44. Brake Mounting Plate
45. Disc Brake (See Separate Parts List)
46. Retainer Ring
47. Drive Shaft
48. Outer Bearing Retainer
49. Retainer Ring
50. Roller Bearing
51. Retainer Ring
52. Retainer Ring
53. Locating Bearing
55. R. H. Bearing Housing
56. Flywheel Brake (Optional - See Separate Parts List)
57. Main Gear
58. Outer Crankshaft Bushing
59. Bushing Dowel
60. Inner Crankshaft Bushing
61. Crankshaft
62. Outer Bearing Cap
63. Inner Bearing Cap
64. Bearing Cap Stud
65. Nut
66. Main Gear Key

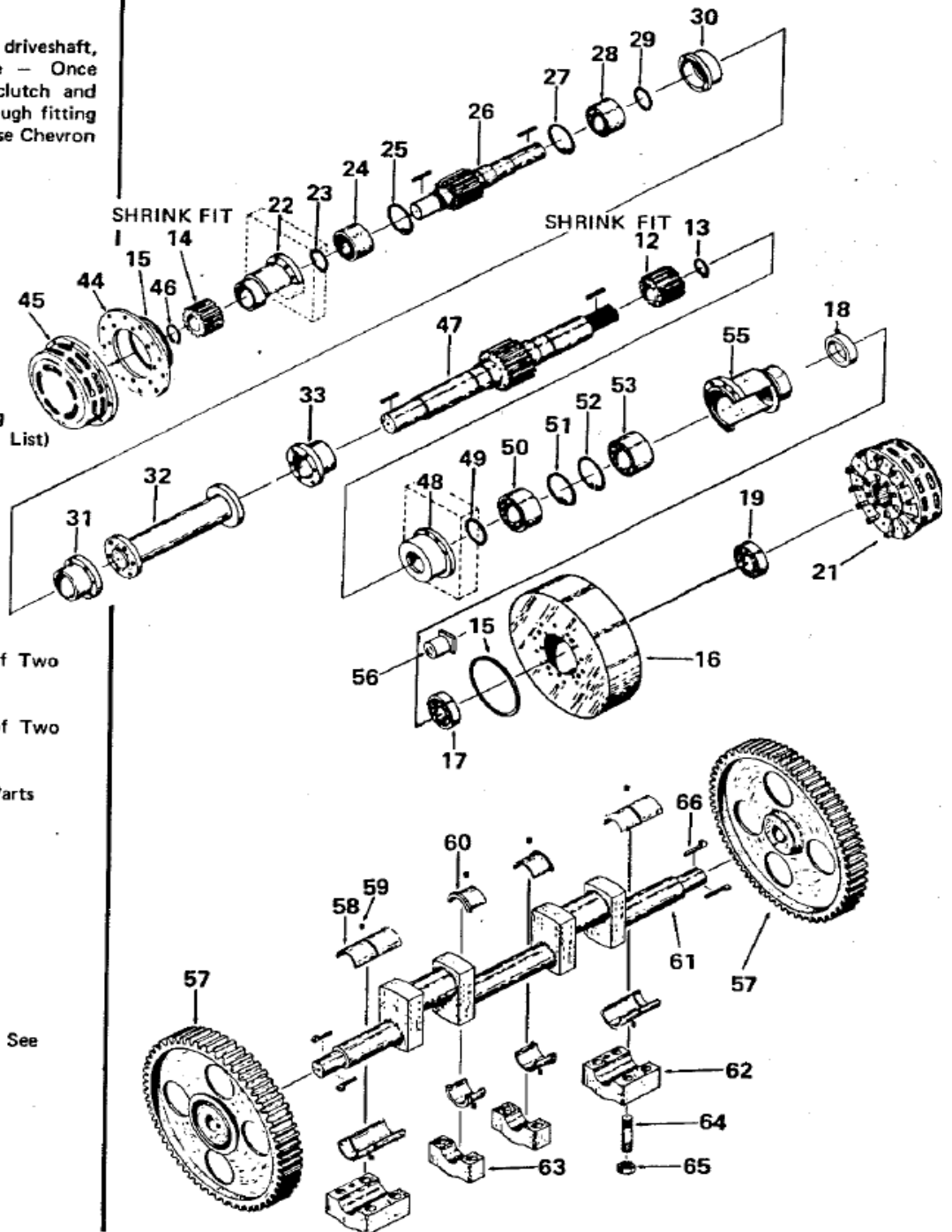

739