

PARTS DESCRIPTION

Torc-Pac Press Drive

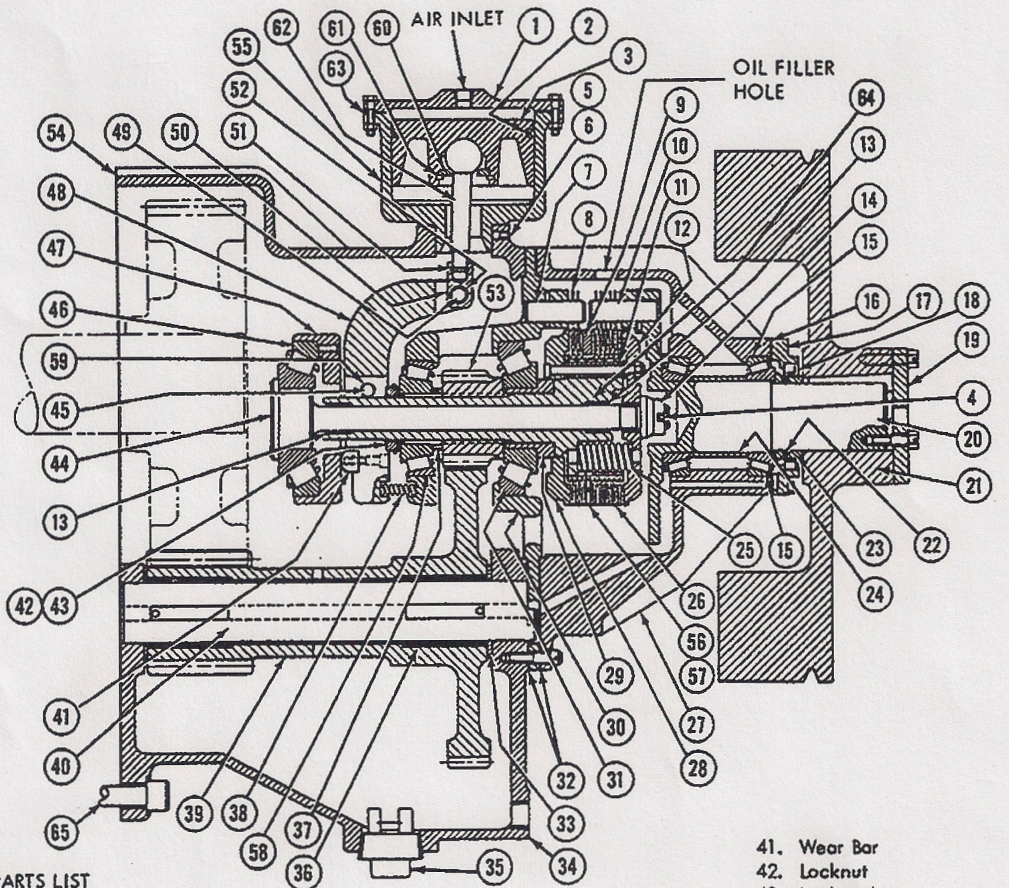

PARTS LIST

- | | | |
|---------------------|----------------------|---------------------------|
| 1. Cylinder Cover | 21. Flywheel | 41. Wear Bar |
| 2. Quad Ring* | 22. "O" Ring* | 42. Locknut |
| 3. Air Piston | 23. Bearing Retainer | 43. Lockwasher |
| 4. Lock Pin | 24. Spacer | 44. Tie Rod |
| 5. Nylon Plug | 25. Spring | 45. Bell Crank Pin |
| 6. Socket Set Screw | 26. Friction Disc | 46. Bearing |
| 7. Drive Pin | 27. Rear Housing | 47. Thrust Collar |
| 8. Disc | 28. Brake Plate | 48. Bell Crank |
| 9. Back Up Plate | 29. Sleeve | 49. Pin |
| 10. Drive Pin | 30. Bearing Support | 50. Clevis |
| 11. Spacer | 31. Bearing | 51. Snap Ring |
| 12. Clutch Plate | 32. Gasket | 52. Bushing |
| 13. Bushing | 33. Thrust Washer | 53. Pinion |
| 14. Special Nut | 34. Front Housing | 54. Gasket |
| 15. Bearing | 35. Magnetic Plug | 55. Cylinder |
| 16. Gasket* | 36. Bushing | 56. Socket Head Set Screw |
| 17. Seal Housing | 37. Spacer | 57. Socket Head Set Screw |
| 18. Oil Seal* | 38. Spring | 58. Bearing |
| 19. Retainer | 39. Cluster Gear | 59. Bushing |
| 20. Input Shaft | 40. Shaft | 60. Ball Retainer |
| | | 61. Retaining Ring |
| | | 62. Piston Shaft |
| | | 63. Gasket* |
| | | 64. Drive Spider |
| | | 65. Mounting Screws |

*Indicates Part Subject To Wear.

Figure 28
Torc-Pac Press Drive

JAN 04 2005

This Drawing and its Contents
are the Proprietary Property
of BLISS CLEARING NIAGARA, INC.
and may only be used for the
purpose it is provided for.

